

5230 Series Regulator

*Single Stage
Brass Barstock Body
Four-Port
Configuration
316L Stainless Steel
Diaphragm
Line Use*



806-5230 shown

Advanced Features

- *Brass Barstock Body*
Smooth surface finish
- *Rear Panel Mountable*
Easy installation
- *Pressure Ranges 0-100 to 0-500 PSIG*
Broad range of applications
- *3,000 PSIG Inlet Pressure Rating*
Safe for use with high pressure cylinders
- *Capsule® Seat*
Increased serviceability and life
- *316L Stainless Steel Diaphragm*
No inboard diffusion
- *Low Wetted Surface Area*
Minimal purge requirements
- *Field Adjustable Pressure Limit*
Safeguard downstream equipment

The 5230 Series regulators are intended for primary pressure control of laser gases supplied from cryogenic liquid cylinders or other low pressure sources where pressure fluctuations can be accepted.

Applications

Materials

Specifications

<p><i>Laser Gases from Pipeline</i> Nitrogen Helium Carbon Dioxide</p> <p><i>Shielding Gases for Laser Welding</i> Argon Helium</p>	<p><i>Body</i> Brass barstock</p> <p><i>Bonnet</i> Chrome-plated die cast zinc</p> <p><i>Seat</i> PTFE</p> <p><i>Filter</i> 10-micron sintered bronze</p> <p><i>Diaphragm</i> 316L stainless steel</p> <p><i>Internal Seals</i> PTFE</p>	<p><i>Maximum Inlet Pressure</i> 3,000 PSIG (210 BAR)</p> <p><i>Temperature Range</i> -40 to 140°F (-40 to 60°C)</p> <p><i>Gauge</i> 2" diameter dual scale brass</p> <p><i>Ports</i> 1/4" FPT</p> <p><i>Helium Leak Integrity</i> 1 x 10⁻⁸ scc/sec</p> <p><i>Cv</i> 0.2</p> <p><i>Weight</i> 2.8 lbs. (2.16 kg)</p>
---	--	---

Flow Performance Curves

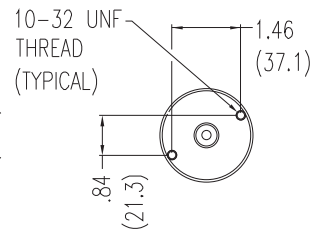
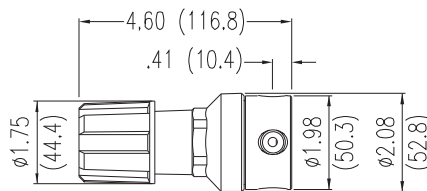
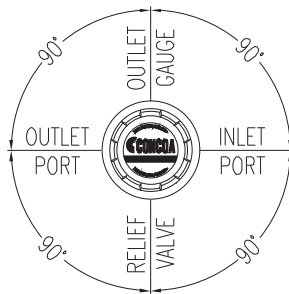
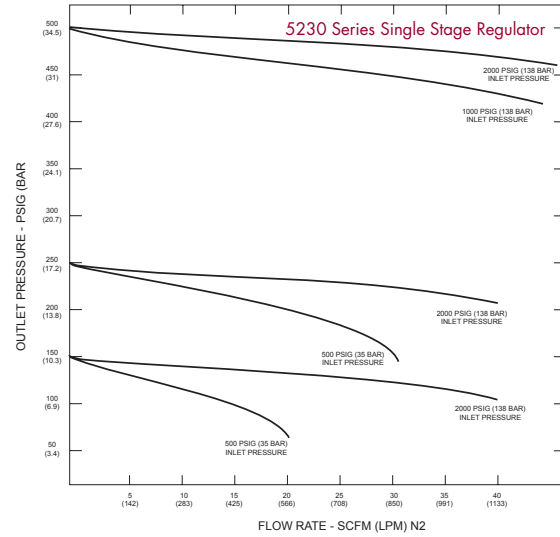
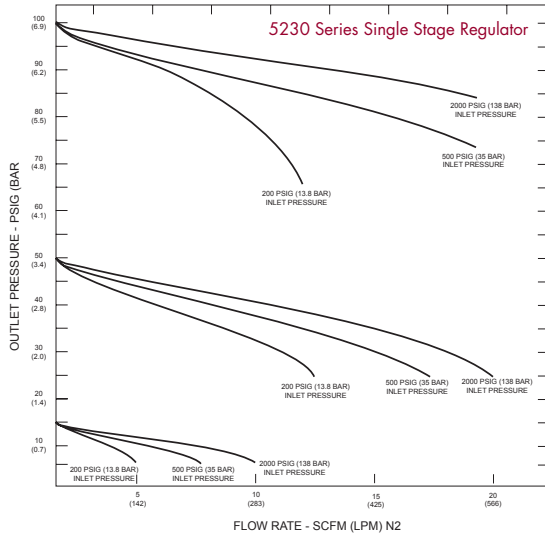

Ordering Information

5230	Part Number	Inlet	Delivery	Gas Service	Outlet
Series 5230	806-5230	1/4" Tube	0-500 PSIG (0-35 BAR)	Any Non-Corrosive Gas	1/4" Stainless Steel Compression Tube Fitting
	806-5232	1/4" Tube	0-250 PSIG (0-18 BAR)	Any Non-Corrosive Gas	
	806-5233	1/4" Tube	0-100 PSIG (0-7 BAR)	Any Non-Corrosive Gas	
	806-5237	1/4" Tube	0-60 SCFH - Argon 0-200 SCFH - Helium	Argon or Helium	1/8" Stainless Steel Compression Tube Fitting

Related Options

Option	Order No.	Description
Laser Gas Stations	See Page 8	Convenient regulator wall mount, including tee, bracket and flexible stainless steel pigtail with check valve in the inlet gland (Check valve not available on CGA 680 inlet models)
Laser Panels	See Page 9	Three Gas Panel delivery systems for the Laser Gases (Helium, Nitrogen and Carbon Dioxide) Tee and Straight Purge configurations to satisfy all requirements
Purge Devices	See Page 47	
Mounting Bracket	835-0204	Rear panel mount bracket kit.