

5260 Series Regulator

Single Stage

*Chrome-Plated
Forged Brass Body*

*316L Stainless Steel
Diaphragm*

Liquid Cylinder



806-5265 shown

Advanced Features

- *Designed for Low Inlet Pressures*
Optimized flow with liquid cylinders
- *Large Capsule® Seat*
Permits flow rates unobtainable with conventional regulators
- *3,000 PSIG Inlet Pressure Rating*
Safe for use with high pressure cylinders
- *Field Adjustable Pressure Limit*
Safeguard downstream equipment
- *Convuluted Diaphragm*
Smooth pressure changes
- *Standard Relief Valve*
Diaphragm and gauge protection

The 5260 Series regulators are designed specifically for primary pressure control of assist gases supplied from cryogenic liquid cylinders for use in medium flow (up to 1,500 SCFH) and medium pressure (up to 200 PSIG) applications. The line version can be used in piping systems for lasing.

Applications

Laser Assist Gases from Liquid Cylinders

Nitrogen and Oxygen from liquid cylinders with flows up to 1,500 SCFH 325 or 500 PSIG cylinder heads

Laser Assist Gases from Pipeline

Nitrogen and Oxygen

Laser Beam Purge

Nitrogen or clean, dry air from a generator or cryogenic source requiring up to 1,000 CFH

Materials

Body

Chrome-plated forged brass

Bonnet

Chrome-plated die cast zinc

Seat

PTFE

Filter

10-micron sintered bronze

Diaphragm

316L stainless steel

Internal Seals

PTFE

Specifications

Maximum Inlet Pressure

3,000 PSIG (210 BAR)

Temperature Range

-40 to 140°F (-40 to 60°C)

Gauge

2 ½" diameter dual scale brass

Ports

¼" FPT

Helium Leak Integrity

1 x 10⁻⁸ scc/sec

Cv

0.28

Weight

2.28 lbs. (1.26 kg)

CONCOA

1501 Harpers Road • Virginia Beach, VA 23454 USA

1.800.225.0473 • 757.422.8330 • Fax: 757.422.3125 • www.concoa.com

Flow Performance Curves

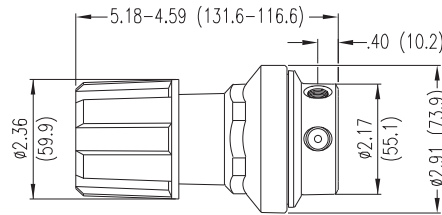
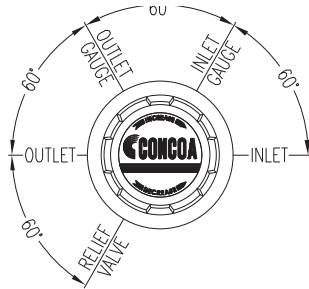
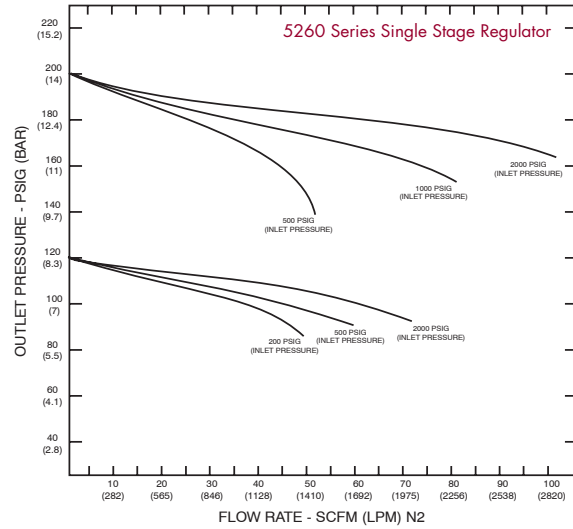
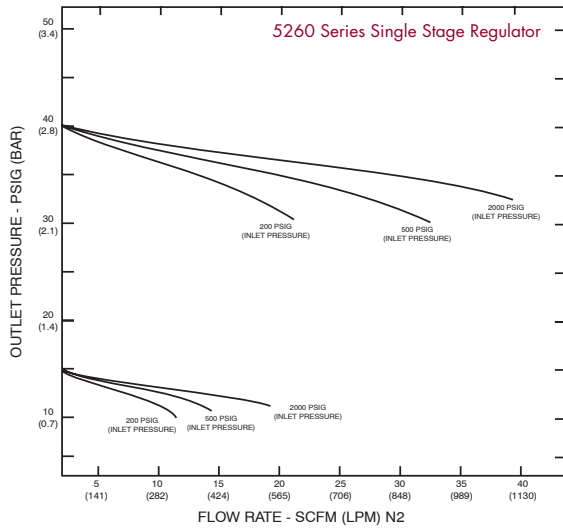

ASSIST GAS SUPPLY

Ordering Information

5260	Part Number	Inlet	Delivery Pressure	Gas Service	Outlet
Series 5260	806-5260	1/4" Tube Inlet	0-200 PSIG (0-14 BAR)	Universal Line Regulator	1/4" Stainless Steel Compression Tube Fitting
	806-5261	CGA 320	0-200 PSIG (0-14 BAR)	Carbon Dioxide	
	806-5265	CGA 580	0-200 PSIG (0-14 BAR)	Inert Gases (Nitrogen, Argon & Helium)	
	806-5266	CGA 540	0-200 PSIG (0-14 BAR)	Oxygen	
	806-5267	CGA 540	0-200 PSIG (0-14 BAR)	Oxygen with 4,000 PSI Inlet Gauge	
	806-5268	CGA 580	0-200 PSIG (0-14 BAR)	Inert with 4,000 PSI Inlet Gauge	
	806-5263	1/4" FPT	0-200 PSIG (0-14 BAR)	Universal Line Regulator	1/4" FPT

Related Options

Option	Order No.	Description
Laser Gas Stations	See Page 8	Convenient regulator wall mount, including tee, bracket and flexible stainless steel pigtail with check valve in the inlet gland (Check valve not available on CGA 680 inlet models)
Purge Devices	See Page 47	Tee and Straight Purge configurations to satisfy all requirements